

TRITON[®] C SERIES

COMMERCIAL SAND FILTERS

For commercial and high-end residential swimming pools and other water applications. Available in flow rates from 98 to 141 gallons per minute.

Triton C and C-3 Series filters are designed for high efficiency and easy maintenance in high capacity commercial pool applications. A superior internal design levels the sand bed and produces an even water flow for the most efficient filtration possible. Our multi-diffuser

system and slotted layer design give the Triton C filter superior filtration capacity and flow for longer cycles between cleanings, which significantly reduces operating costs.

Three-inch bulkheads (C-3 models) cut friction loss in half, and flanged connections don't require special adapters.

The Triton C Series filter is engineered with single-piece tanks for superior

strength, and made from the toughest materials available to withstand harsh chemicals and weather.

Capable of increased flow rates to 20 gpm per square foot of filter media, these filters are ideal for commercial applications and tandem installations when several filters are required.



STANDARD FEATURES

- 2" and 3" plumbing connections for maximum flow.
- 2" drains for easy winterizing.
- C and C-3 Series filters available in 30" and 36".
- Can be combined for tandem installation.
- NSF Listed.

TRITON® C SERIES

COMMERCIAL SAND FILTERS

TRITON HD FILTER

The Triton heavy duty (HD) filter is a thirty-inch fiberglass filter that offers a maximum operating pressure of 75 PSI. This filter is specifically designed for special high-pressure commercial applications that require up to 98 gpm, and is ideal for all heavy-duty commercial applications.

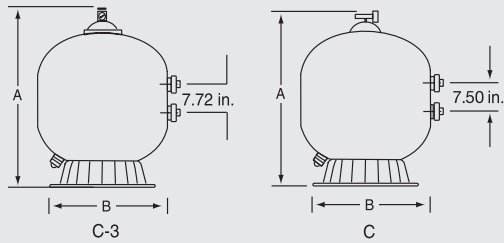

TR100 HD

Triton Commercial Series Sand Filter Specifications

Model Number	Filter Area Sq. Ft.	Flow Rate		Turnover Capacity Gallons		Dimension		Media Required	
		15 GPM/sq. ft.*		6 Hours	8 Hours	A	B	Sand	Sand/Gravel
TR100C	4.91	74		26,640	35,520	39 3/4"	30 1/2"	600 lbs.	450 lbs./150 lbs.
TR140C	7.06	106		38,160	50,880	45 1/4"	36 1/2"	925 lbs.	650 lbs./275 lbs.
TR100C-3	4.91	74		26,640	35,520	39 3/4"	30 1/2"	600 lbs.	450 lbs./150 lbs.
TR140C-3	7.06	106		38,160	50,880	45 1/4"	36 1/2"	925 lbs.	650 lbs./275 lbs.

*15 GPM/sq.ft. typical commercial flow rate, Triton C Filters are NSF approved for 5-20 GPM/sq.ft.

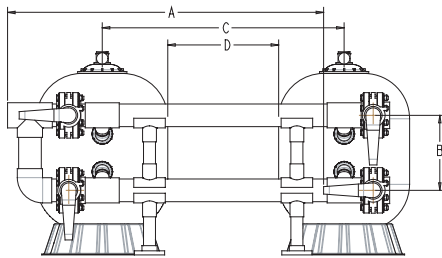

Two Filter System	A	B	C	D	Total Wt.
3" - TR100C	82 3/4"	17 15/16"	48" Min.	18" Min.	2,300 lbs.
3" - TR140C	88 3/8"	17 15/16"	54" Min.	18" Min.	3,200 lbs.
4" - TR140C	95 3/4"	19 35/64"	54" Min.	18" Min.	2,300 lbs.
6" - TR140C	111 3/4"	24 7/32"	54" Min.	18" Min.	3,550 lbs.

Note: 6" piping needs to be rotated upward as shown at 25° so handle will clear the floor.

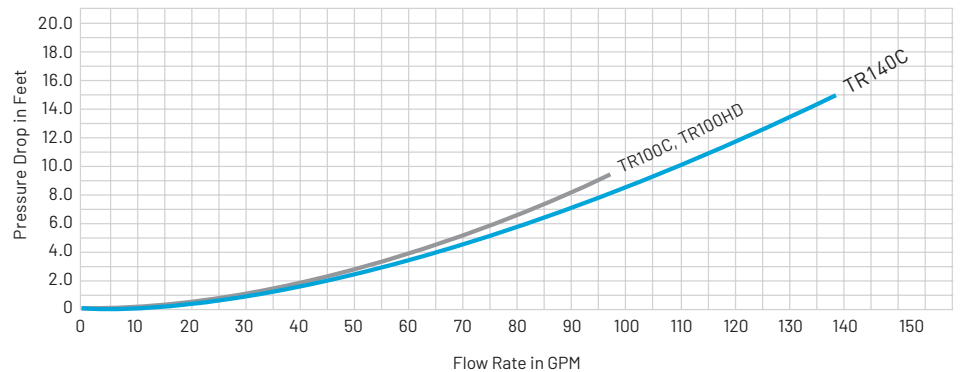

1620 HAWKINS AVE | SANFORD, NC 27330 | UNITED STATES | 800.831.7133 | pentair.com

All Pentair trademarks and logos are owned by Pentair plc, or one of its global affiliates. Triton® is a registered trademark of Pentair Water Pool and Spa, Inc. and/or its affiliated companies in the United States and/or other countries. Because we are continuously improving our products and services, Pentair reserves the right to change specifications without prior notice.

Pentair is an equal opportunity employer.

PI-151 11/19 ©2019 Pentair Water Pool and Spa, Inc. All rights reserved.